

Title Number : LN13405

This title is dealt with by Land Registry, Telford Office.

The following extract contains information taken from the register of the above title number. A full copy of the register accompanies this document and you should read that in order to be sure that these brief details are complete.

Neither this extract nor the full copy is an 'Official Copy' of the register. An official copy of the register is admissible in evidence in a court to the same extent as the original. A person is entitled to be indemnified by the registrar if he or she suffers loss by reason of a mistake in an official copy.

This extract shows information current on 4 MAY 2016 at 19:14:11 and so does not take account of any application made after that time even if pending in the Land Registry when this extract was issued.

REGISTER EXTRACT

Title Number	: LN13405
Address of Property	: The Uxbridge Arms Public House, 29 Bath Terrace, (SE1 6PS)
Price Stated	: £400,000
Registered Owner(s)	: URBANICITY (NO. 10) LLP (LLP Regn. No. OC374796) of 11a High Street, Cobham KT11 3DH.
Lender(s)	: None

Title number LN13405

This is a copy of the register of the title number set out immediately below, showing the entries in the register on 4 MAY 2016 at 19:14:11. This copy does not take account of any application made after that time even if still pending in the Land Registry when this copy was issued.

This copy is not an 'Official Copy' of the register. An official copy of the register is admissible in evidence in a court to the same extent as the original. A person is entitled to be indemnified by the registrar if he or she suffers loss by reason of a mistake in an official copy. If you want to obtain an official copy, the Land Registry web site explains how to do this.

A: Property Register

This register describes the land and estate comprised in the title. Except as mentioned below, the title includes any legal easements granted by the registered lease but is subject to any rights that it reserves, so far as those easements and rights exist and benefit or affect the registered land.

SOUTHWARK

- 1 (16.09.1936) The Leasehold land shown edged with red on the plan of the above Title filed at the Registry and being The Uxbridge Arms Public House, 29 Bath Terrace, (SE1 6PS).
- 2 (16.09.1936) Short particulars of the lease(s) (or under-lease(s)) under which the land is held:
Date : 2 September 1936
Term : 99 years from 29 September 1935
Rent : £55
Parties : (1) The London County Council
(2) Watney Combe Reid & Co Limited
- 3 The landlord's title is registered.
- 4 Unless otherwise mentioned the title includes any legal easements granted by the registered lease(s) but is subject to any rights that it reserves, so far as those easements and rights exist and benefit or affect the registered land.

B: Proprietorship Register

This register specifies the class of title and identifies the owner. It contains any entries that affect the right of disposal.

Title absolute

- 1 (01.07.2013) PROPRIETOR: URBANICITY (NO. 10) LLP (LLP Regn. No. OC374796) of 11a High Street, Cobham KT11 3DH.
- 2 (01.07.2013) The price stated to have been paid on 29 May 2013 was £400,000.

End of register

H. M. LAND REGISTRY GENERAL MAP

LONDON SHEET VII.95 SECTION J (EXTRACT FROM)

Scale $\frac{1}{1056}$

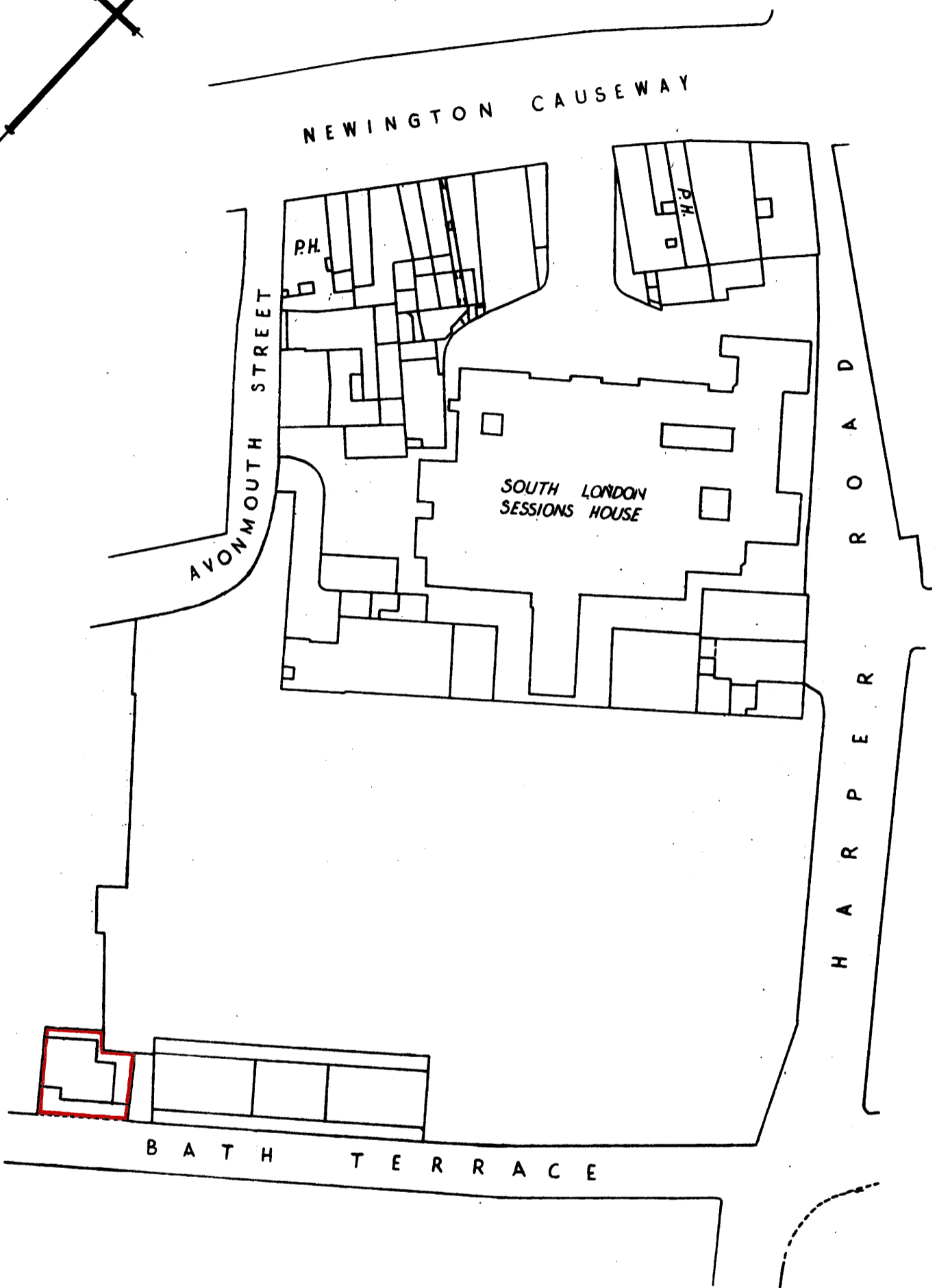
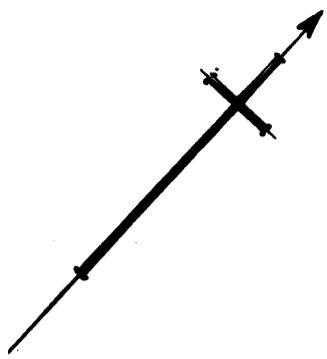

Crown Copyright Reserved

Filed Plan of Title No. **LN 13405**



This is a copy of the title plan on 4 MAY 2016 at 19:14:11. This copy does not take account of any application made after that time even if still pending in the Land Registry when this copy was issued.

This copy is not an 'Official Copy' of the title plan. An official copy of the title plan is admissible in evidence in a court to the same extent as the original. A person is entitled to be indemnified by the registrar if he or she suffers loss by reason of a mistake in an official copy. If you want to obtain an official copy, the Land Registry web site explains how to do this.

The Land Registry endeavours to maintain high quality and scale accuracy of title plan images. The quality and accuracy of any print will depend on your printer, your computer and its print settings. This title plan shows the general position, not the exact line, of the boundaries. It may be subject to distortions in scale. Measurements scaled from this plan may not match measurements between the same points on the ground.

This title is dealt with by Land Registry, Telford Office.

© Crown Copyright. Produced by Land Registry. Further reproduction in whole or in part is prohibited without the prior written permission of Ordnance Survey. Licence Number 100026316.